



## SUPER TITAN

ULTIMATE HIGH CURRENT SOLUTION



# SUPER TITAN

Super Titan is the ultimate high-current power conditioner in IsoTek's Ultra Reference series. It is designed to maximise the performance of high-end power amplifiers and forms part of our flagship two-box system, although it can also be used alone. Super Titan is designed to deliver an unrestricted, low-impedance, ultra-clean power supply by removing pollution from the mains without limiting the dynamics or transient ability of the connected audio equipment.

## Why 32Amp?

In order to deliver up to 32Amps continuously, the Super Titan incorporates silver-plated 32A locking Neutrik input and output sockets. To ensure optimum results, IsoTek has also designed a unique 32A power cable called Intense, developed especially for the Super Titan – no other power conditioner brand can boast such attention to detail.



## OVERVIEW

Building upon the design of the existing Titan, IsoTek's new flagship was inspired by the emergence of a new breed of super-powerful high-end amplifiers whose current demands set specific challenges that are not fully met by existing mains conditioning products. In the process, IsoTek has designed a power conditioner that outperforms all others currently available, both on paper and in practice.

In the six years since its launch, the multi-award-winning Titan has built a reputation as the finest mains conditioner on the market, described by the critics at What Hi-Fi? Sound and Vision as "a revelation" and by those at Hi-Fi News as "the most impressive mains filter we've ever heard". Its innovative technology, designed specifically for power amplification, forms an epoch-making partnership with the IsoTek Nova, which delivers the same exacting level of quality for source components and preamplifiers.

The arrival of Super Titan heralds the start of a new high-end range of power optimisation components called Ultra Reference. It takes the Titan blueprint and enhances every element of its design to deliver a new benchmark in the field of mains conditioning for high-performance audio and AV systems.

## TECHNOLOGY

Super Titan is designed to meet the specific demands of all high-end power amplifiers. However, in terms of its ability to deliver current, it is almost twice as powerful as the original Titan. Super Titan is capable of delivering 7,360W of continuous power, with 35,500W of transient power on tap.

IsoTek's unique Direct Coupled Design® concept – originally developed for the Titan and further enhanced for Super Titan – delivers 800% more bandwidth and virtually unlimited high-current filtering, incorporating a group of four seven-stage filters in a series parallel combination. A simple comparison may be drawn to multiple-cylinder engines; the four sections combine to make one 'super' seven-element filter, which is inherently superior to engineering a single large filter. This system is far more effective than using one large isolation transformer, which cannot maintain transient power.

IsoTek's proprietary KERF© technology secures a pure, symmetrical signal path through the unit, while the Polaris-X© network removes crosstalk and improves component-from-component isolation. In addition, a massive 135,000 Amps of instantaneous and repeatable surge protection safeguards valuable audio equipment against spikes and surges in the mains supply – no other device on the market can match this level of protection.

The combination of these unique technologies enables Super Titan to remove both differential and common mode noise, improving sonic clarity and definition, without restricting transient ability.

## ISIS – UNIQUE ISOLATION

Fashioned from aluminium, Super Titan's rigid outer casing is cradled in a specially developed support structure called ISIS© (Independent System Isolation Support). The main unit is point-clamped between two panels at the top and bottom, each of which is formed of a special resonance-damping material

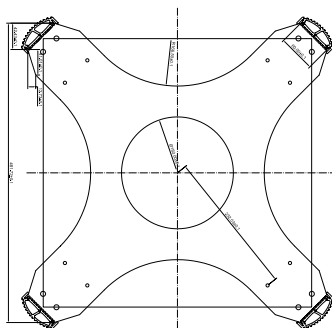

sandwiched between two ultra-dense Corean plates, with the overall structure supported by four substantial aluminium pillars.

ISIS© was developed in conjunction with Kurt Olbert, the creator of RDC and an acknowledged expert in developing proprietary materials for audio applications. Its purpose is two-fold. First, it reduces the effect of airborne vibration and microphony, as well as subsonic vibration and

resonance in the device itself, which are detrimental to the performance of electronics. Second, its shape, strength and resonance-damping abilities provide a perfect platform on which to place other components, its stackable design saving space when using more than one IsoTek unit.

**No matter how powerful the amplifier, however current-hungry it may be, Super Titan delivers a super-clean, ultra-consistent supply of electricity without limitation, ensuring the world's best amplifiers perform to their full potential every time.**



“Switching to the Super Titan was one of those jaw dropping moments that tend to be rare in audio”

[Adventures in High-Fidelity Audio](#)

### SPECIFICATIONS

- 4 High quality silver plated 32A outlets
- 7360 Watt Continuous Power
- 35,500 Watt Transient Power
- 135,000 Amps Surge Protection
- 100-240 Voltage range
- 50-60Hz Mains Frequency Range
- 32Amps Maximum Current
- 500x500x300mm (WxDxH)
- 30Kg

“Switching to the Super Titan was one of those jaw dropping moments that tend to be rare in audio... the system gained more depth, detail, better instrument separation and a fuller more extended bass, whilst the acoustic space became more obvious. These improvements were obvious within a few seconds. Very impressive indeed.”

**Adventures in High-Fidelity Audio**

